

# VWW1107 Pressure Window

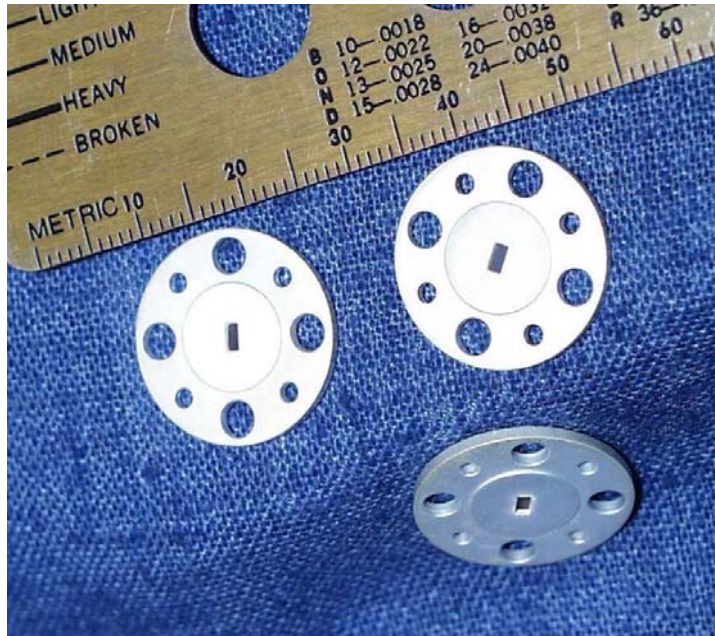

## Features:

- **Frequency Range: 92.0 - 96.0 GHz**
- **VSWR: 1.30:1 max across band  
1.10:1 max at 94 GHz**
- **Insertion Loss: 0.18 dB max.**
- **Vacuum tight to  $10^{-8}$**
- **Finish: Silver plate**
- **WG Size: WR10**

## Description:

W-Band quartz pressure window.

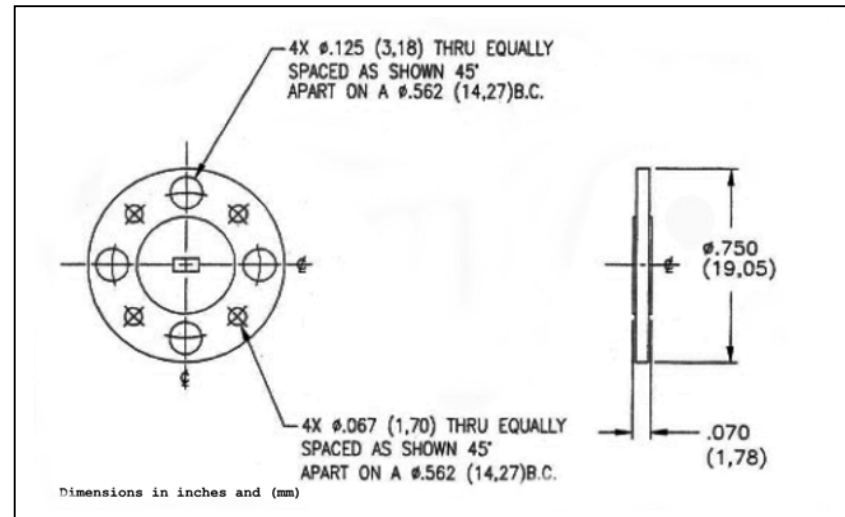

150 Sohier Road  
Beverly, Massachusetts 01915



Phone: 978-922-6000 Fax: 978-922-2736  
E-Mail: [marketing@bmd.cpii.com](mailto:marketing@bmd.cpii.com)  
Internet: [www.cpii.com/bmd](http://www.cpii.com/bmd)